

STANDARD VOLTAGES

115V-1PH-60HZ
230V-1PH-60HZ

MADE IN USA

MODEL	CAPACITY	REF. COMP.	IN/DUT	SHIP WGT (lbs)
UA10A	10	1/6	1/2" NPT	60
UA20A	20	1/5	1/2" NPT	62
UA25A	25	1/4	1/2" NPT	65

DESIGN CONDITIONS

CAPACITY IS BASED ON CAGI STANDARD NO. ADF100.
INLET TEMP 100 F, INLET PRESSURE 100 PSIG
AMBIENT TEMP 100 F, 38 F DEWPOINT
MAWP 232 PSIG

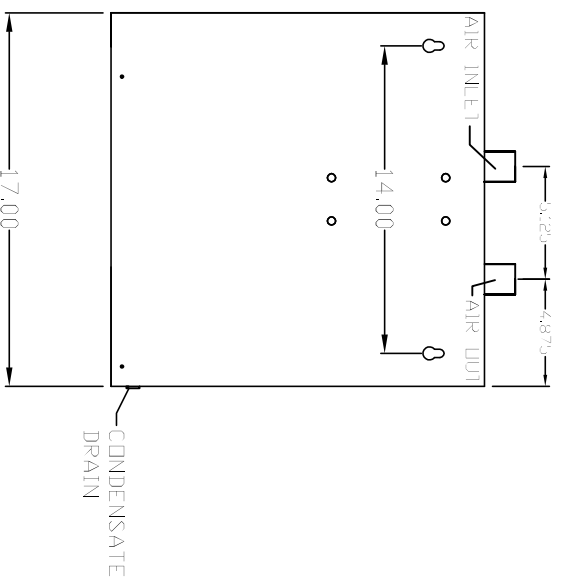
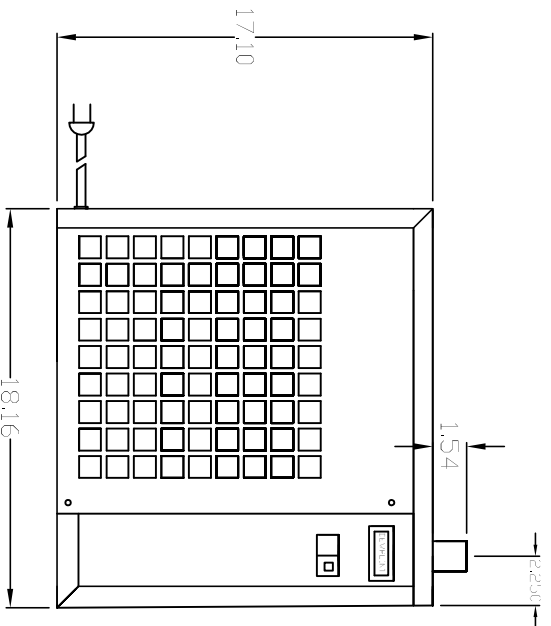

SHIPS BY UPS

STANDARD FEATURES

- DEWPOINT INDICATOR
- ON/OFF SWITCH
- DRYER ON LIGHT
- TECUMSEH COMPRESSOR
- 3 IN 1 ALUMINUM HEAT EXCHANGER MODULE
- AIR TO AIR
- AIR TO REFRIGERANT
- STAINLESS STEEL MESH SEPERATOR

- R134A REFRIGERANT
- HOT GAS BYPASS VALVE
- CONDENSER FAN MOTOR
- FAN CYCLING CONTROL
- POWDER COATED STEEL CABINET
- EASY ACCESS CABINET
- 6 FOOT POWER CORD AND PLUG
- PROGRAMMABLE DRAIN

MACCAIR INC. www.maccair1.com
4123 Pioneer dr
Walled Lake, MI 48390

UA10A, UA20A & UA25A
DIMENSIONAL

Rev	Rev.Date	Rev.Date	UA-DIM-25-1

DATE 10-2016